

# Danube, Rhine, Main & Moselle deck plans

## Emerald Sky & Emerald Star

• Built: 2014 • Length: 443ft (135m) • Guests: 180 • Cabins: 91 • Crew Members: 52

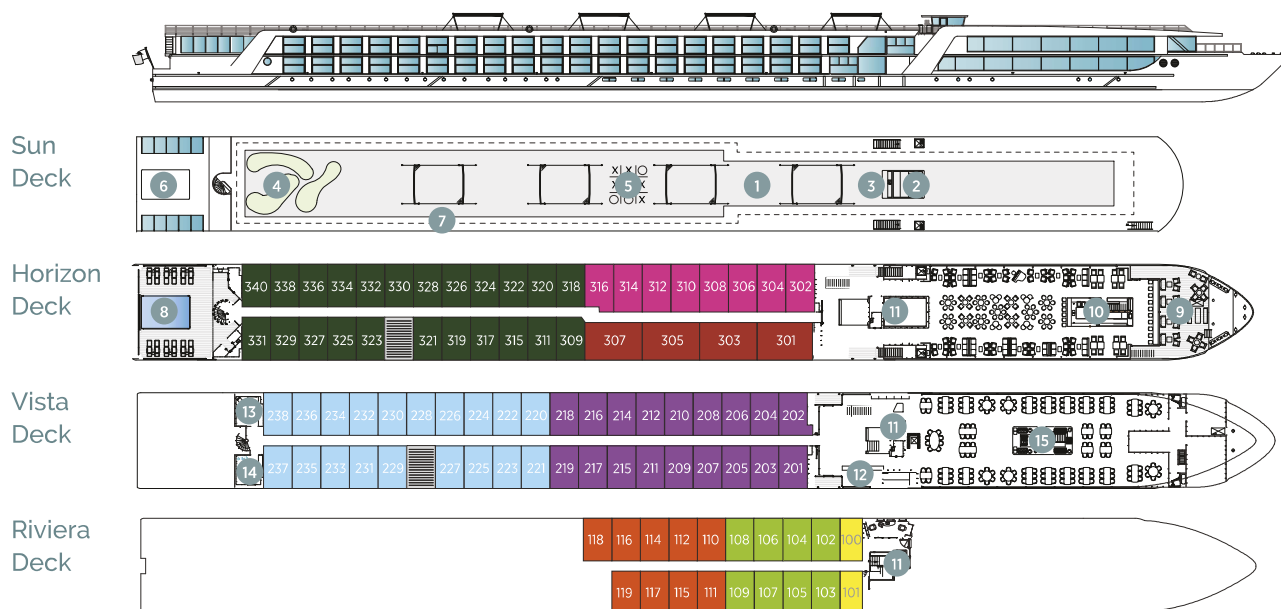

Cabin Categories		
Horizon Deck		Size ft <sup>2</sup> (m <sup>2</sup> )
CAT SA	Owner's One-Bedroom Suite	315ft <sup>2</sup> (29.3m <sup>2</sup> )
CAT S	Grand Balcony Suite*	210ft <sup>2</sup> (19.5m <sup>2</sup> )
CAT A	Emerald Panorama Balcony Suite	180ft <sup>2</sup> (16.7m <sup>2</sup> )
Vista Deck		Size ft <sup>2</sup> (m <sup>2</sup> )
CAT B	Emerald Panorama Balcony Suite	180ft <sup>2</sup> (16.7m <sup>2</sup> )
CAT C	Emerald Panorama Balcony Suite	180ft <sup>2</sup> (16.7m <sup>2</sup> )
Riviera Deck		Size ft <sup>2</sup> (m <sup>2</sup> )
CAT D	Emerald Stateroom	162ft <sup>2</sup> (15m <sup>2</sup> )
CAT E	Emerald Stateroom	162ft <sup>2</sup> (15m <sup>2</sup> )
CAT ES	Emerald Single Stateroom	117ft <sup>2</sup> (10.9m <sup>2</sup> )

- 1 Sun Deck with Deck Chairs\*
- 2 Navigation Bridge
- 3 Sky Barbecue
- 4 Golf Putting Green
- 5 Games Area
- 6 Retractable Glass Roof
- 7 Walking Track
- 8 Daytime Pool & Bar/Evening Cinema
- 9 The Terrace
- 10 Horizon Bar & Lounge
- 11 Lift
- 12 Reception
- 13 Wellness Area
- 14 Fitness Area
- 15 Reflections Restaurant

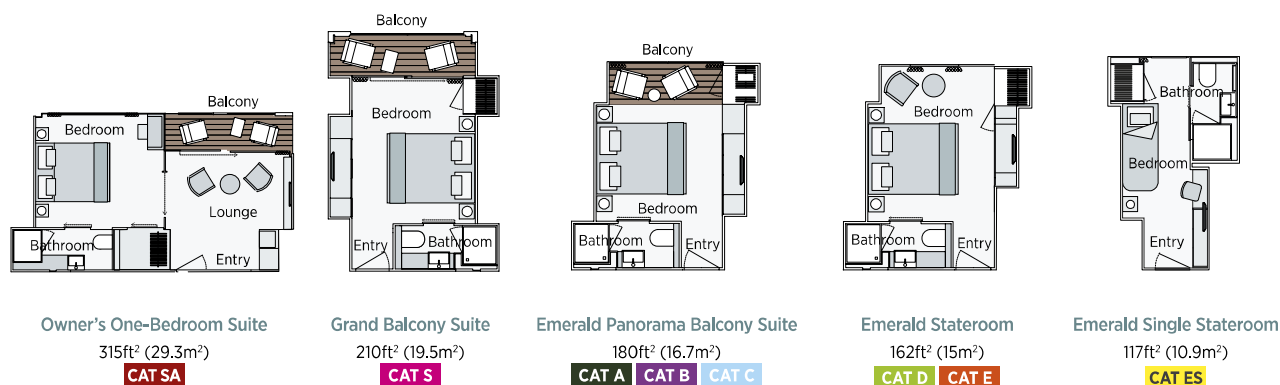

**Important Information:** On Emerald Sky and Emerald Star, cabin 202 has modified entry, bathroom configuration with personal assistance fittings and has no decked area with table and chairs. The cabin and deck plans, sizes and photographs are an indication only and are subject to variation.

\*Due to safety, the Sun Deck will be closed when travelling under low bridges.

\*Cabin 316 has a slightly varied layout.