

Danube, Rhine, Main & Moselle deck plans

Emerald Dawn, Emerald Sun & Emerald Luna

• Built: 2015 & 2020 • Length: 443ft (135m) • Guests: 180 • Cabins: 91 • Crew Members: 52



Sun Deck

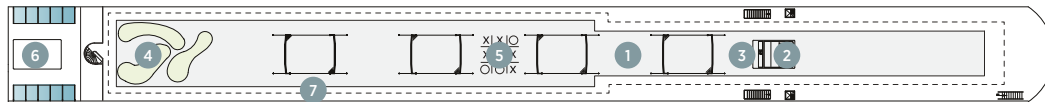

Horizon Deck

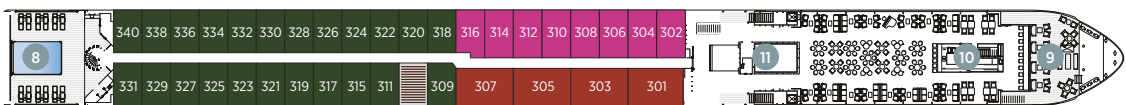

Vista Deck

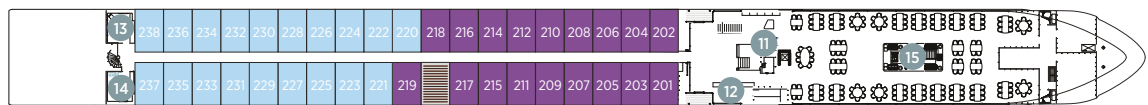

Riviera Deck

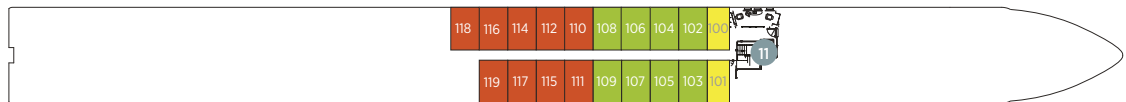

| Cabin Categories | | |
|------------------|--------------------------------|--|
| Horizon Deck | | |
| CAT SA | Owner's One-Bedroom Suite | 315ft ² (29.3m ²) |
| CAT S | Grand Balcony Suite* | 210ft ² (19.5m ²) |
| CAT A | Emerald Panorama Balcony Suite | 180ft ² (16.7m ²) |
| Vista Deck | | |
| CAT B | Emerald Panorama Balcony Suite | 180ft ² (16.7m ²) |
| CAT C | Emerald Panorama Balcony Suite | 180ft ² (16.7m ²) |
| Riviera Deck | | |
| CAT D | Emerald Stateroom | 162ft ² (15m ²) |
| CAT E | Emerald Stateroom | 162ft ² (15m ²) |
| CAT ES | Emerald Single Stateroom | 117ft ² (10.9m ²) |

- 1 Sun Deck with Deck Chairs*
- 2 Navigation Bridge
- 3 Sky Barbecue
- 4 Golf Putting Green
- 5 Games Area
- 6 Retractable Glass Roof
- 7 Walking Track
- 8 Daytime Pool & Bar/Evening Cinema
- 9 The Terrace
- 10 Horizon Bar & Lounge
- 11 Lift
- 12 Reception
- 13 Wellness Area
- 14 Fitness Area
- 15 Reflections Restaurant

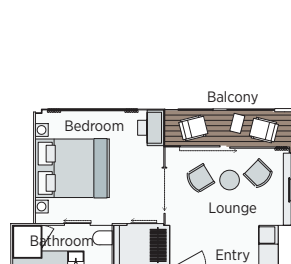

Owner's One-Bedroom Suite
315ft² (29.3m²)
CAT SA

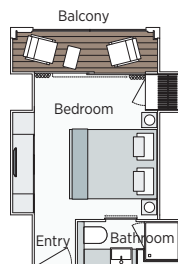

Grand Balcony Suite
210ft² (19.5m²)
CAT S

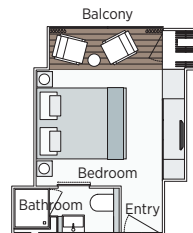

Emerald Panorama Balcony Suite
180ft² (16.7m²)
CAT A CAT B CAT C

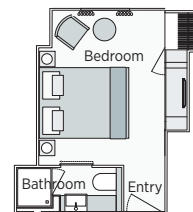

Emerald Stateroom
162ft² (15m²)
CAT D CAT E

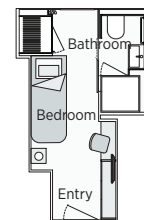

Emerald Single Stateroom
117ft² (10.9m²)
CAT ES

Important Information: The cabin and deck plans, sizes and photographs are an indication only and are subject to variation.
*Due to safety, the Sun Deck will be closed when travelling under low bridges.
*Cabin 316 has a slightly varied layout.

Danube, Rhine, Main & Moselle deck plans

Emerald Destiny

• Built: 2017 • Length: 443ft (135m) • Guests: 180 • Cabins: 91 • Crew Members: 52

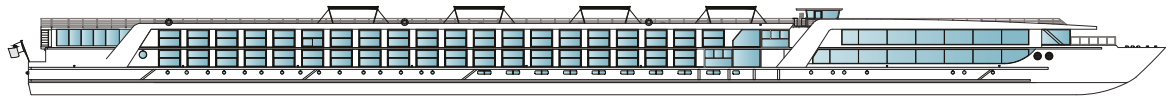

Sun Deck

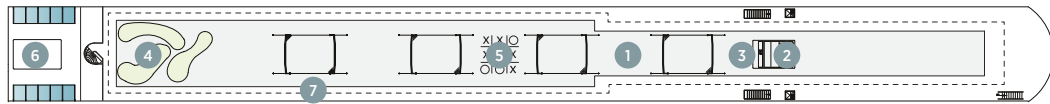

Horizon Deck

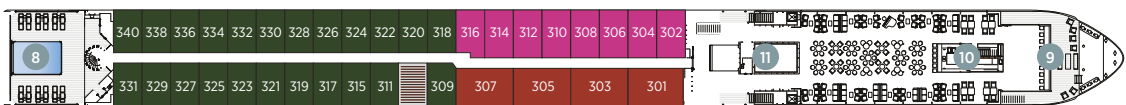

Vista Deck

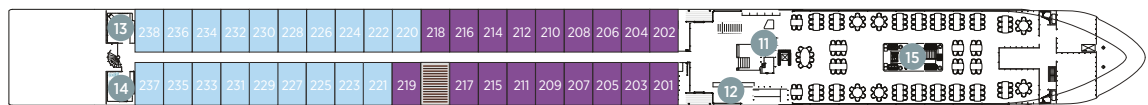

Riviera Deck

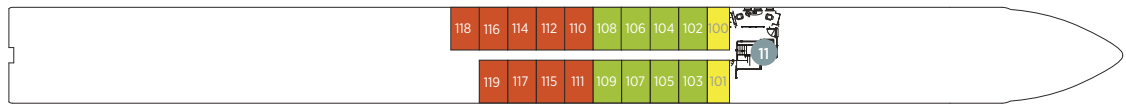

| Cabin Categories | | |
|------------------|--------------------------------|-----------------|
| Horizon Deck | | |
| CAT SA | Owner's One-Bedroom Suite | 315ft² (29.3m²) |
| CAT S | Grand Balcony Suite* | 210ft² (19.5m²) |
| CAT A | Emerald Panorama Balcony Suite | 180ft² (16.7m²) |
| Vista Deck | | |
| CAT B | Emerald Panorama Balcony Suite | 180ft² (16.7m²) |
| CAT C | Emerald Panorama Balcony Suite | 180ft² (16.7m²) |
| Riviera Deck | | |
| CAT D | Emerald Stateroom | 162ft² (15m²) |
| CAT E | Emerald Stateroom | 162ft² (15m²) |
| CAT ES | Emerald Single Stateroom | 117ft² (10.9m²) |

- 1 Sun Deck with Deck Chairs*
- 2 Navigation Bridge
- 3 Sky Barbecue
- 4 Golf Putting Green
- 5 Games Area
- 6 Retractable Glass Roof
- 7 Walking Track
- 8 Daytime Pool & Bar/Evening Cinema
- 9 The Terrace
- 10 Horizon Bar & Lounge
- 11 Lift
- 12 Reception
- 13 Wellness Area
- 14 Fitness Area
- 15 Reflections Restaurant

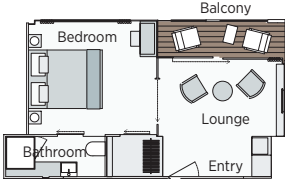

Owner's One-Bedroom Suite
315ft² (29.3m²)
CAT SA

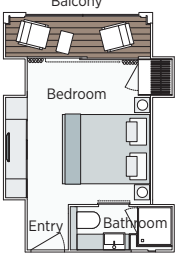

Grand Balcony Suite
210ft² (19.5m²)
CAT S

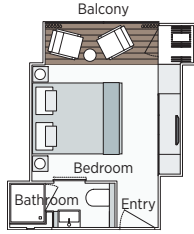

Emerald Panorama Balcony Suite
180ft² (16.7m²)
CAT A CAT B CAT C

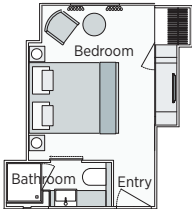

Emerald Stateroom
162ft² (15m²)
CAT D CAT E

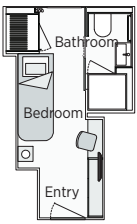

Emerald Single Stateroom
117ft² (10.9m²)
CAT ES

Important Information: The cabin and deck plans, sizes and photographs are an indication only and are subject to variation.
 *Due to safety, the Sun Deck will be closed when travelling under low bridges.
 *Cabin 316 has a slightly varied layout.